

INNOVAPANEL UPDATED ENGINEER DESIGN BRIEF

Updated branded engineer-facing performance overview incorporating ASTM E72 structural testing, Miami-Dade TAS 201/202/203 hurricane testing, axial tension / pull-test screening data, and five-story conceptual design feasibility parameters for the patented InnovaPanel system.



STRONGER. LIGHTER. SMARTER. ENGINEERED FOR PERFORMANCE. BUILT FOR THE FUTURE.

InnovaPanel is a patented composite structural panel system that delivers superior strength, energy efficiency, and hurricane resilience in one integrated building solution.



BUILT DIFFERENT. BUILT BETTER.

- ✓ Patented composite MgO structure with EPS core
- ✓ Tested to ASTM E72 for shear and axial performance
- ✓ Miami-Dade NOA & Florida Product Approved
- ✓ High thermal performance continuous insulation
- ✓ Non-combustible & mold resistant
- ✓ Faster construction with fewer skilled trades

DESIGNED FOR THE EYE OF THE STORM.



COMPLETE BUILDING SOLUTION

Structure, insulation, sheathing, and substrate in one integrated panel.

ROOF PANEL SYSTEM
8" MgO ROOF PANELS

FLOOR SYSTEM
24' READY JOIST SPAN
MGO SHEATHING

WALL PANEL SYSTEM
MgO FACES + EPS CORE
COMPOSITE STRUCTURAL PANEL

FIRE RATED ASSEMBLY
2-HOUR FLOOR/CEILING ASSEMBLY

ENGINEERED FOR HURRICANE RESILIENCE

Tested. Proven. Trusted.

EXCEPTIONAL WIND PERFORMANCE

- ✓ Miami-Dade NOA Approved
- ✓ 150 MPH Design Wind (Florida Building Code)
- ✓ High impact resistance with continuous load path
- ✓ Reduced overturning with lighter dead load

CONTINUOUS LOAD PATH

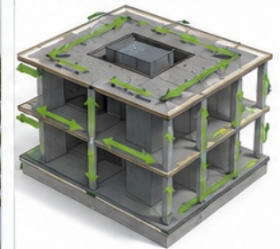

Roof, walls, and floors work together as a complete structural system.

UNMATCHED PERFORMANCE

SHEAR STRENGTH
(ASTM E72)
4,633 plf
ALLOWABLE (ASD)

LIGHTWEIGHT
8-12 psf
WALL WEIGHT

FIRE RESISTANCE
2-HOUR
RATED ASSEMBLY

THERMAL PERFORMANCE
(R-VALUE)
R-21+
TYPICAL WALL

MOISTURE RESISTANT
MOLD, ROT & CORROSION PROOF

INSTALLATION SPEED
2-3X
FASTER THAN CMU

ENGINEER-LEVEL SYSTEM COMPARISON 5-STORY RESIDENTIAL BUILDING SYSTEMS

| PERFORMANCE CATEGORY | INNOVAPANEL COMPOSITE SYSTEM | REINFORCED CMU | WOOD FRAMING | OSB SIP | STEEL STUD ASSEMBLY |
|------------------------------------|------------------------------|----------------|---------------|---------------|---------------------|
| WALL WEIGHT (psf) | 8 - 12 | 40 - 50 | 15 - 20 | 12 - 16 | 10 - 14 |
| SHEAR CAPACITY (ASTM E72) | 4,633 plf | 2,000 - 2,500 | 1,000 - 1,500 | 2,000 - 3,000 | 1,500 - 2,000 |
| TYPICAL DRIFT PERFORMANCE | EXCELLENT | GOOD | FAIR | GOOD | GOOD |
| THERMAL PERFORMANCE (R-VALUE WALL) | R-21+ | R-4 - R-6 | R-13 - R-15 | R-16 - R-20 | R-13 - R-16 |
| INSTALLATION SPEED | 2 - 3X FASTER | SLOW | STANDARD | FASTER | STANDARD |
| LABOR INTENSITY | LOW | HIGH | MEDIUM | MEDIUM | MEDIUM |
| MOISTURE RESISTANCE | EXCELLENT | POOR | FAIR | FAIR | GOOD |
| FIRE PERFORMANCE | 2-HOUR RATED | 2-HOUR+ | 1-HOUR+* | 1-HOUR+* | 1-HOUR+* |

* With additional gypsum protection

TYPICAL WALL SECTION



TYPICAL FLOOR/ROOF ASSEMBLY



SUSTAINABLE BY DESIGN

- ✓ Low embodied energy
- ✓ Recyclable & eco-friendly materials
- ✓ Reduces waste on the jobsite
- ✓ Supports green building goals



Partner with InnovaPanel.
Design with Confidence. Build with Strength.
www.innovapanel.com



Updated Engineering Highlights:

- ASTM E72 composite wall testing demonstrated ultimate axial compression loads exceeding 56,000 lbs average.